

- Budget Style
Commercial & Residential Use.
- UL listed (UL file No.R15839),
CE Certification
(Number:0359-CPR-00071-02).
- Heavy duty Rack and pinion,
High Strength Cast Aluminum Body.
- Two separate valves adjustable
closing & latching speed.
- Work Temperature -30°C To 60°C.
- Universal Application : Standard,
Top-Jamb ,Parallel Arm Instruction.
(P.A bracket be provided upon request).

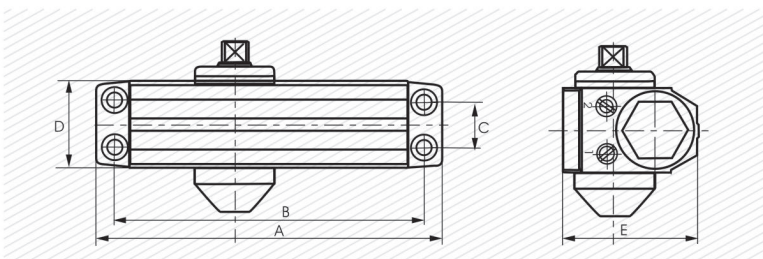

LD 60

DOOR CLOSER



Finish Available:

- Silver
- PNP(Polished Nickel Plated)
- Gold
- PB (Polished Brass)
- Bronze
- SNP(Satin Nickel Plated)

Type	Dimension (mm)					Door Width(mm)
	A	B	C	D	E	
LD 60	148	132	20	37	57.5	850